

Creator's Precision Lead Stretcher Instructions



Made In USA

1. Measure out a 7' board (not included) to secure lead stretcher to for a 6' length of lead (Board can vary depending on your needs.)



2. Screw in the independent lead vise into one end of the board until tight (Screws not included)

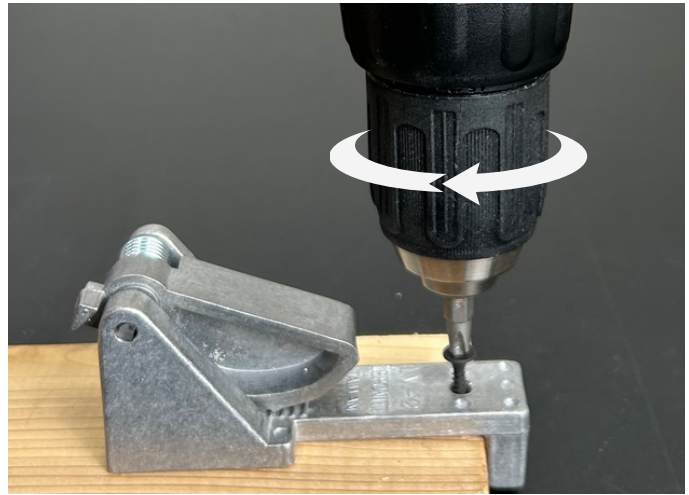

3. On the other end of the board position the stretcher against the end of the board and secure it using the two holes on the bar.

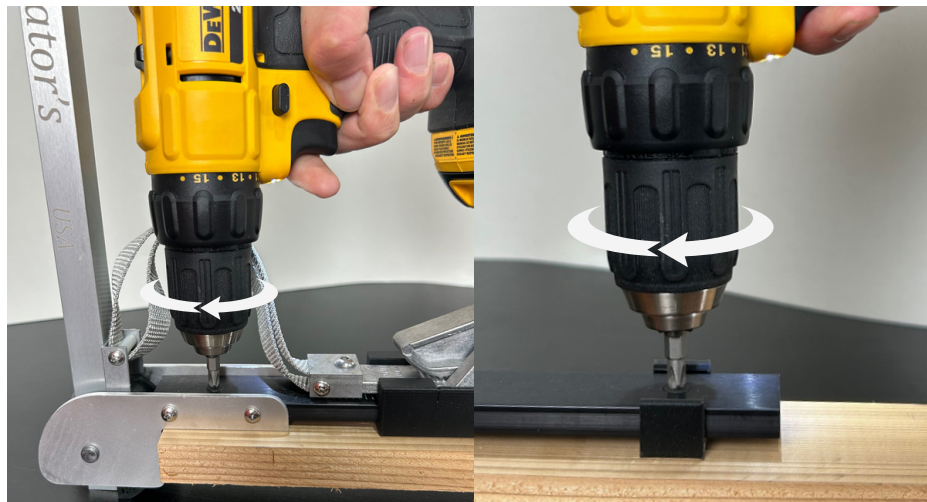

Tip: Use one or two C-Clamp's to further secure board to your table (not included)



Tip: Lead Stretcher can also be secured directly to table's edge



4. Insert lead into both vices

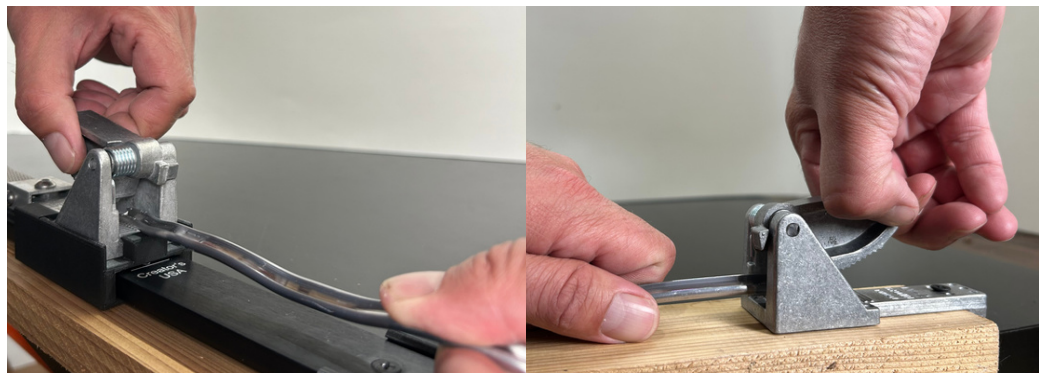

Tip: It helps to push down on the vise after inserting the lead to get a better grip on the lead



5. Once lead is secured pull on the lever until the lead starts to straighten out, then continue pulling on the lever about 1.5" for a 6' length of lead

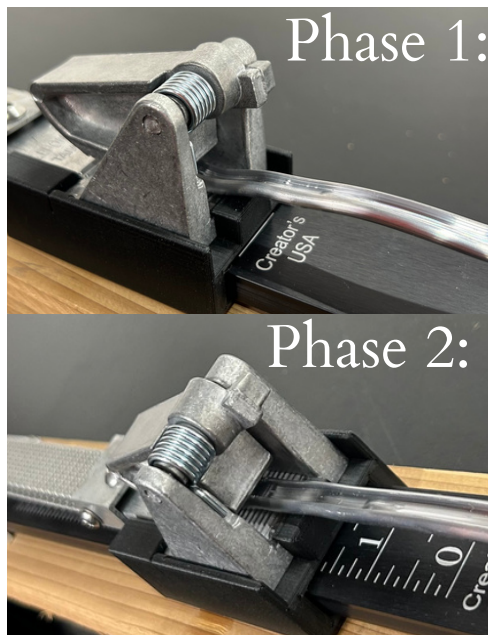
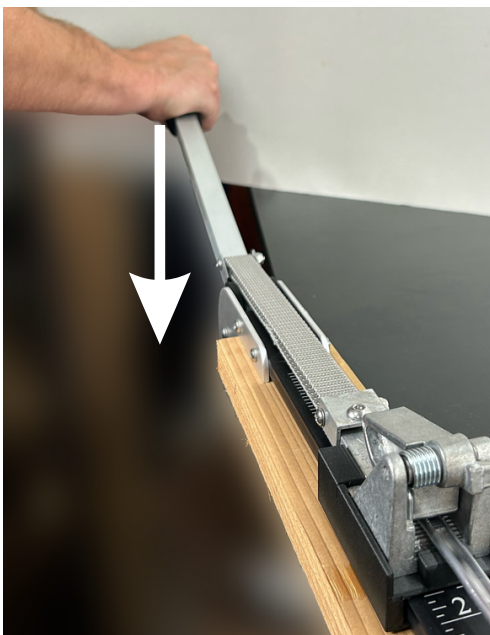

6. Once the lead has been stretched to the desired length, remove the lead from the vises starting with the one on the lever side. Be careful when doing this as the lever will swing down into a neutral position.

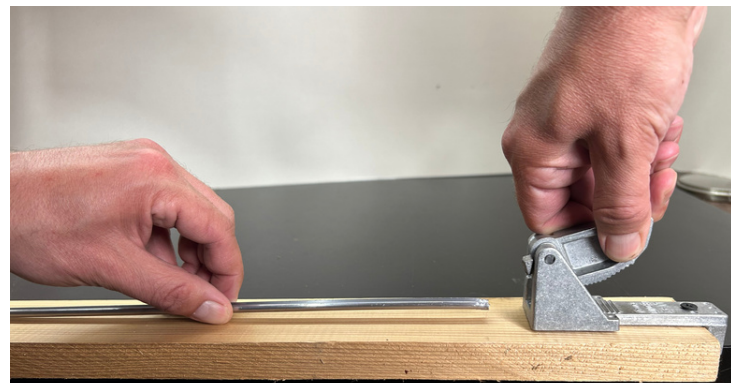
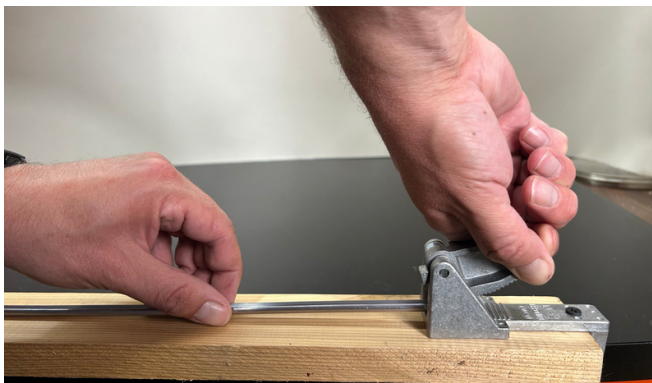

Questions? Contact us!
Phone : 847-477-3863

Visit us at
www.creatorsbrand.com